

Notes:

This style of Aurora slot car hub, used in their 1960's Vibrator ("Vibe") and Thunderjet ("T-Jet") series, was utilized by Wah Ming Chang in his communicators as both the control knobs and, when inverted, the bezels upon which the rhinestones were glued (see photos at right).

While the maximum diameter, when measured across many hubs, is a consistent 0.248", the maximum height can vary between 0.136 and 0.143 inches. This difference is entirely in the varying heights of the "tire spindle" portion. The predominant size from a large batch of hubs was selected for detailing here.

The original hubs were made of chrome-plated injected-molded yellow styrene plastic. Each had a point of contact to the sprue (the channel in which the plastic flowed) on the outer-most edge of the flange. This small patch, many still having excess "flash" attached, is rough and without chrome.

Oxidation and UV over decades can discolor the exposed yellow plastic (where the chrome has worn-off) to orange or brown.

If replicating in spun metal, observe that the outside corners of the original plastic could not hold a razor-sharp edge; that they all had a miniscule roundness of a few ten-thousandths of an inch. No edge could ever cut skin.

For additional details and photographs, reference www.HeroComm.com.

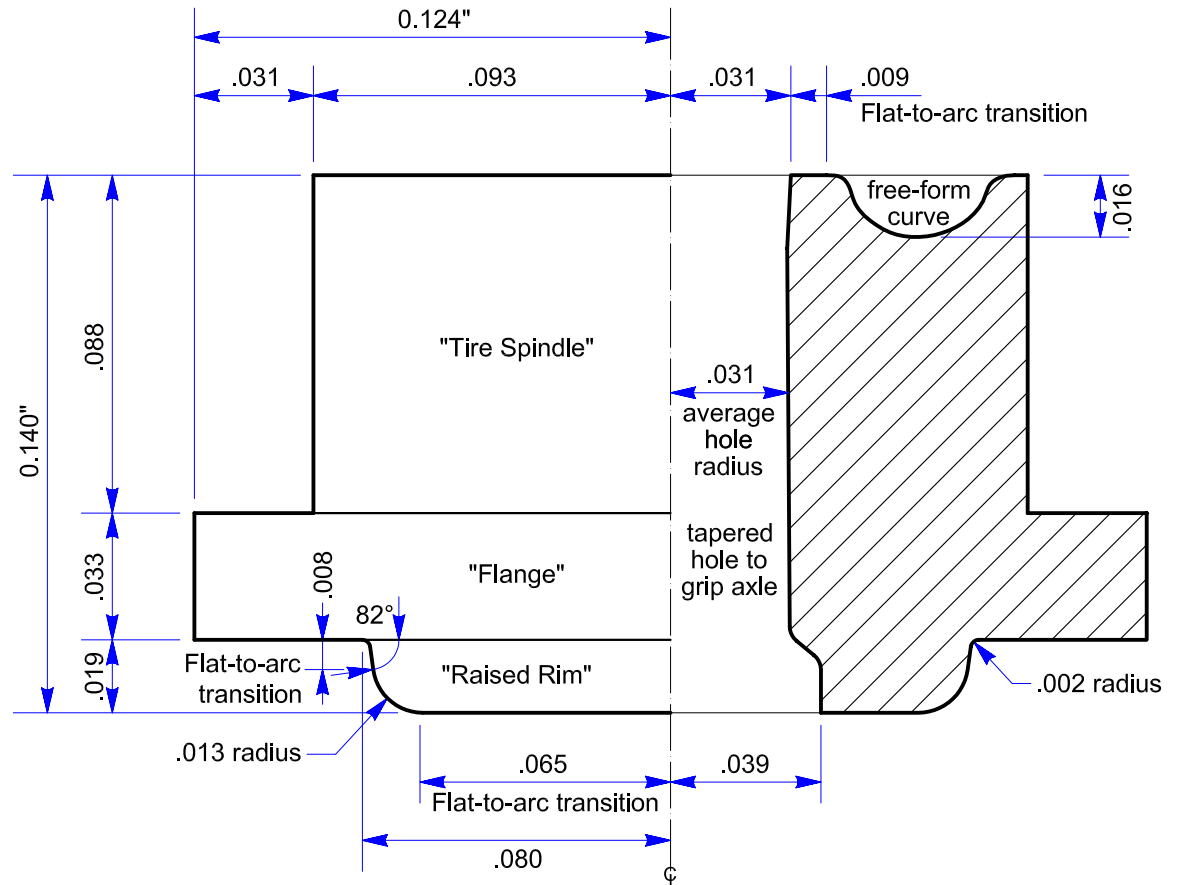
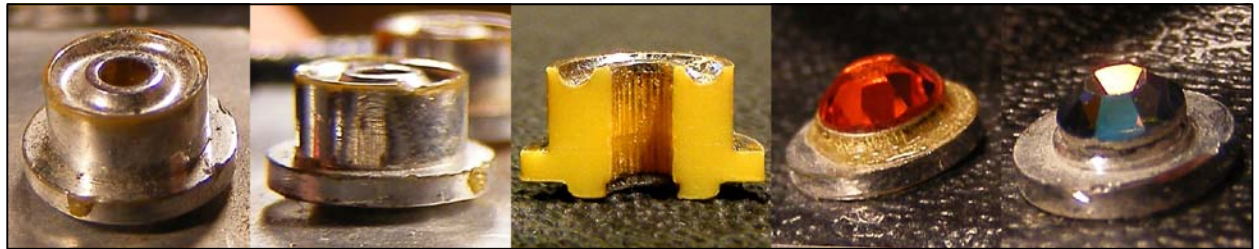

Hub Elevation / Section
(20X full scale)