

Beta hero

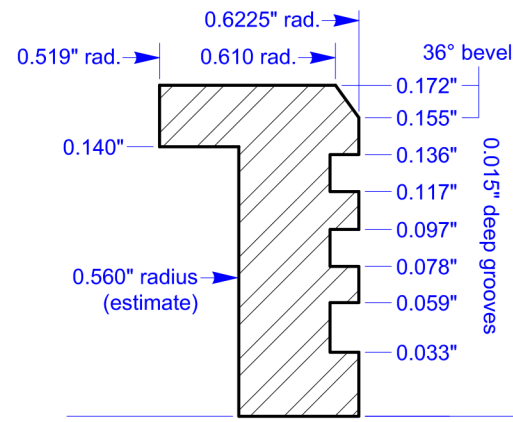

Iota

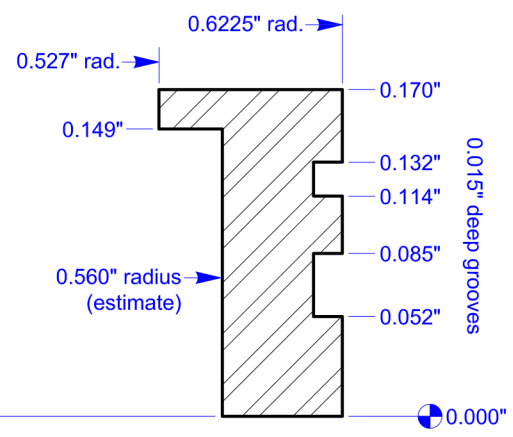

Kappa

(all cross section drawings on this page: 10X full scale)

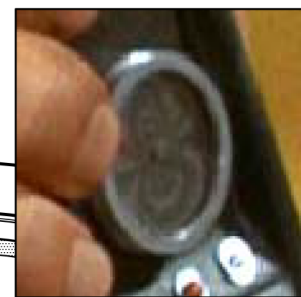

from "Day of the Dove"

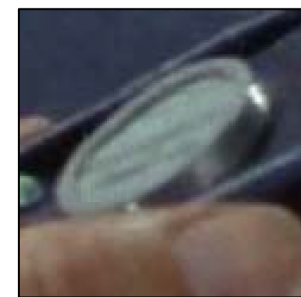

from "Mir"



from Lincoln Enterprises clip

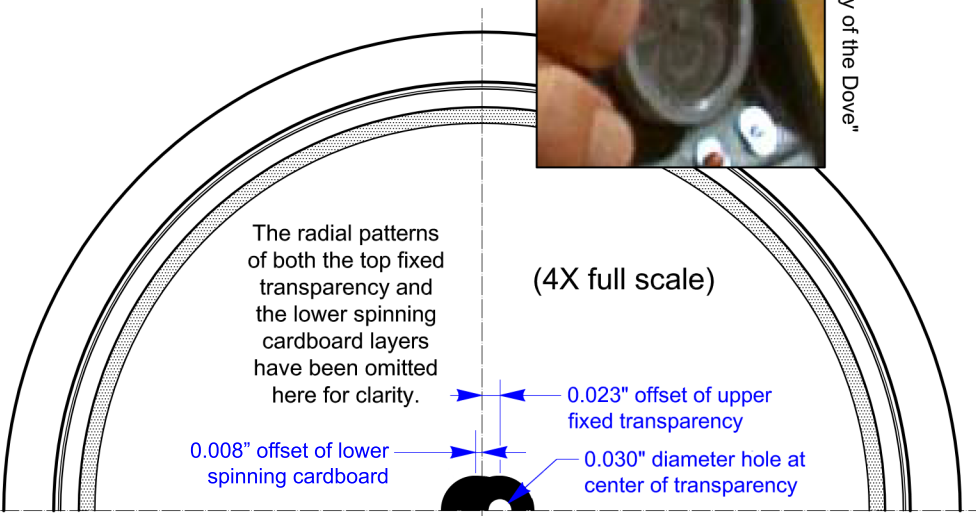

Beta hero: Moiré Pattern Positions

**Page 1 Notes:**

1. These moiré bezel ring dimensions represent our best guess only, as determined by screen caps of various clarity. An initial assumption has been made that they have the same 1.245" outer diameter as those others (Alpha, Epsilon, Zeta) that have actually been measured.
2. In Iota and Kappa, photos show evidence of one large side groove each, so the other smaller grooves shown are conjecture only - given the large one's location.
3. Beta's best close-up suggests the overall dimensions to be like Alpha's, but only the subtle hints of two grooves are visible at standard DVD resolution; these are what are drawn here. Its moiré pattern positions are based on a mere 2.5 seconds of movement seen in one episode.
4. For pattern inserts, additional photos and construction details, reference [www.HeroComm.com](http://www.HeroComm.com).